

Iris S. and Bert L. Wolstein Research Building

Cleveland, OH

Project Description

Client University Hospitals

Building Size 332,000 square feet

Building Constructed 2002

Building Use Research Laboratories

Architect van Dijk Pace Westlake

This new 332,000 gross square foot Research Building transforms the typical research lab, hidden behind closed doors, into collaborative architecture that is visible, open and engaging. Designed as a response to its tight site in Cleveland's University Circle, the architecture projects its research image on the urban street front through its materiality and transparency; yet is carved away in deference to the residential scale to its north side. Putting a human face on research, the building fosters interaction and communication through a collaborative and flexible research environment and oasis-like courtyard.

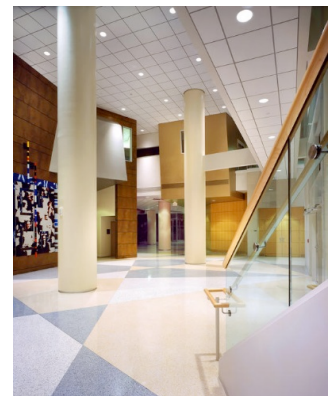
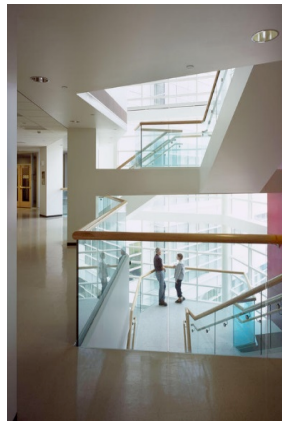

Westlake Reed Leskosky
Formerly van Dijk Pace Westlake